

Annexure 3

Property and Planning Details



Site Property and Planning Details

- 3.1 The site is called the Cobham Drive Substation.
- 3.2 The table below provides important property and planning details in terms of:
- Region/ district;
 - Address, location description and/ or adjacent locations/ features;
 - Grid co-ordinates;
 - Legal description (appellation, SO No., Roll No. and CT);
 - Ownership/ Tenure/ Requiring Authority;
 - Underlying/ adjacent zone and/ or designation status; and
 - Planning Map and Schedule References.

Table 3: Property and Planning Details

Region/ District	Location	Grid Reference	Legal Description	Tenure	Zone/ Overlay/ Designation/ Schedule/ Interests	Plan Map/ Schedule Refs
<ul style="list-style-type: none"> • Waikato Region • Hamilton City 	<ul style="list-style-type: none"> • Existing Cobham Switching Station site. • Intersection of Cobham Drive and Anglesea Street. 	NZMG S14 27114771E, 6376187N or thereabouts	<ul style="list-style-type: none"> • Pt allot 279, Town of Hamilton West • SO 42257 • DP 9104 • Better Utilisation (GAZ 1965 P389) • Valuation ref: 4165/82500 	Land Information New Zealand	Residential (High Density)	HCDP ¹ Map S21
	See Figure 2		See Figure 3 & Appendix 3	See Figure 3	See Figure 4	

- 3.3 The proposal is shown below on an aerial photograph, Terraviva and planning maps.

¹ Hamilton City District Plan (Operative September 2002)



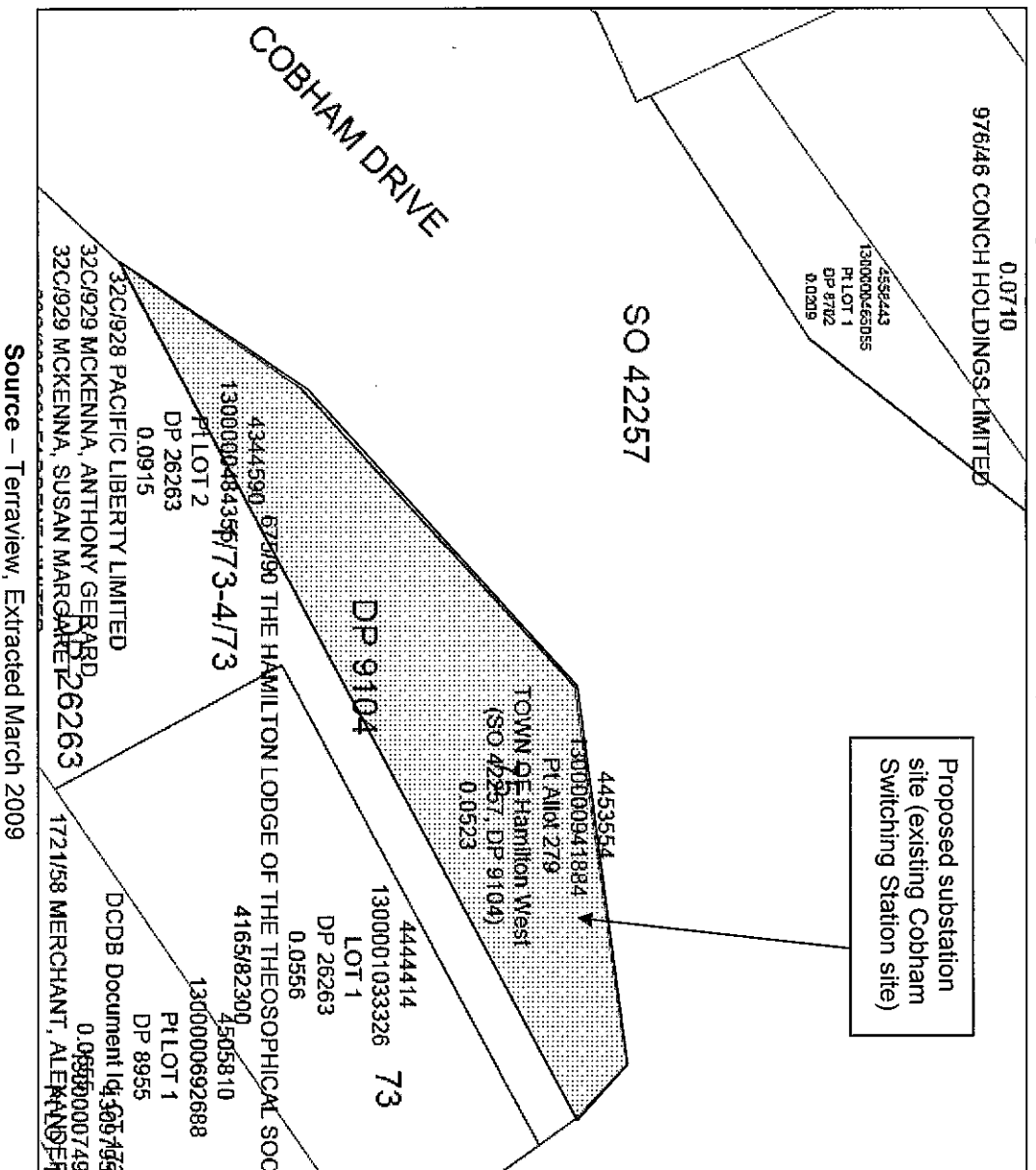
Figure 2: Cobham Substation Site Aerial Photograph



Source – Terraviva Platinum, June 2008

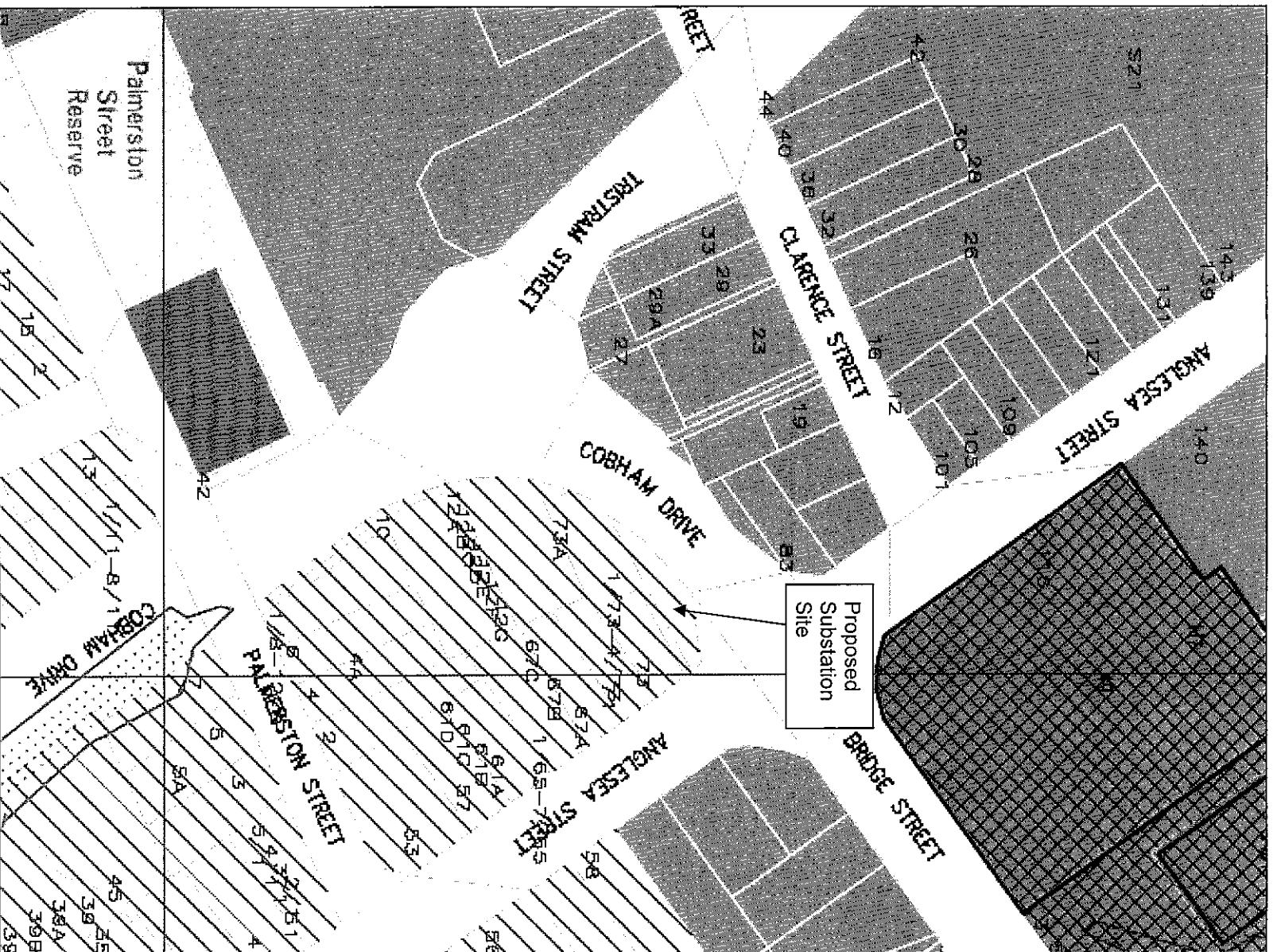


Figure 3: Cobham Substation Site Legal Description Details



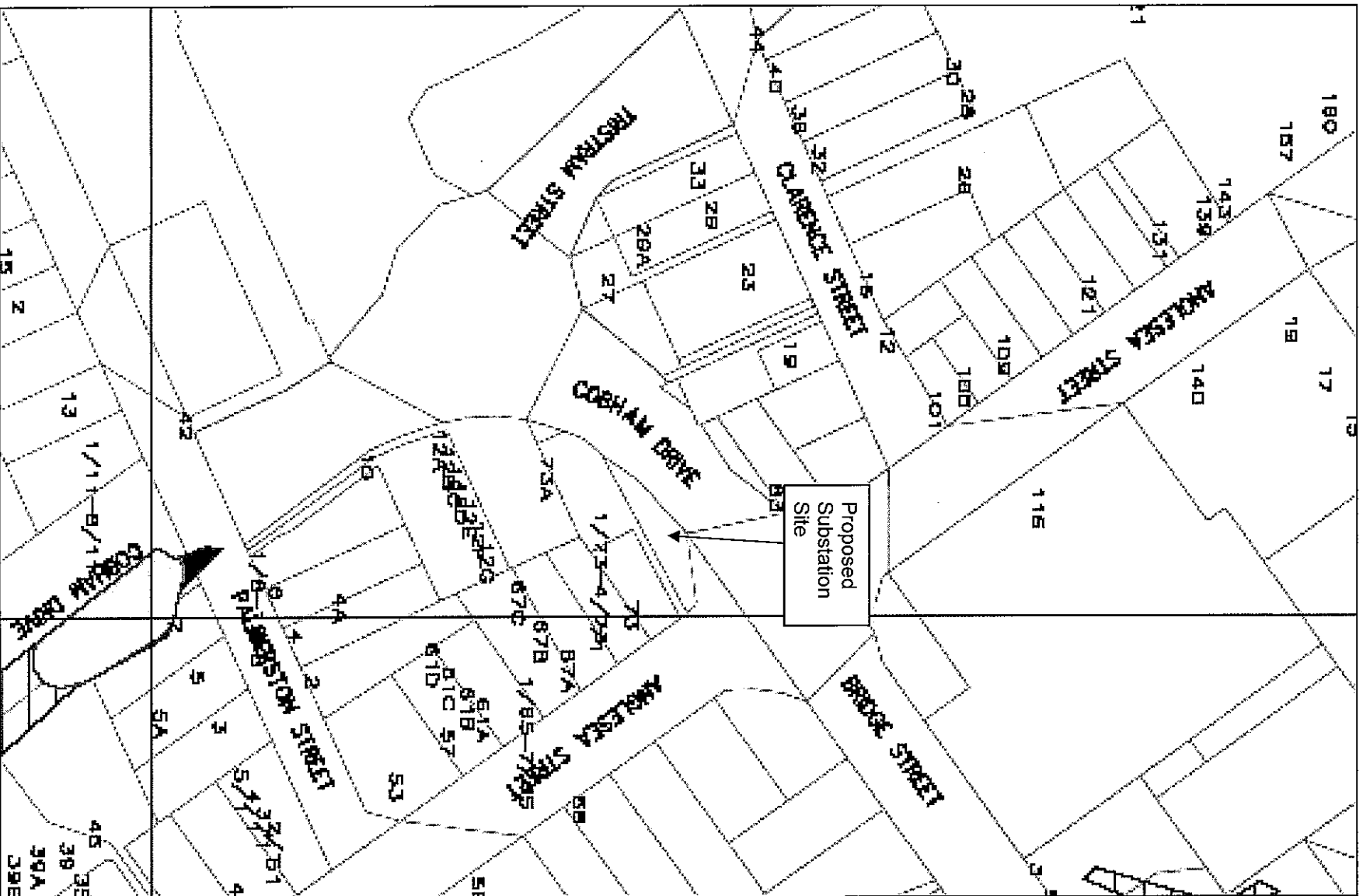
Source — Terraviva, Extracted March 2009

Figure 4: Cobham Substation Zoning Details (Proposed Plan)



Source – Hamilton City Proposed District Plan Maps (Map S21)

Figure 5: Cobham Substation Environmental Protection Overlays (Proposed Plan)



Source: Hamilton City District Environmental Protection Overlay Maps (Map S21)